

QikFit port

QIKFIT PORT from OE has been designed to provide a discrete, flexible and low cost installation solution for our QIKFIT TUF HP USB charging and data/AV modules.

Designed to install in an industry standard 80mm diameter aperture in a wide range of furniture, QIKFIT PORT can be supplied preconfigured with your choice of QF05 modules or as part of a component kit for onsite configuration.

When fitted with one or two of our new QIKFIT TUF HP USB charging module and installed in combination with a concealed QIKFIT Power Supply or QIKPAC battery, PORT will provide high power USB charging with unrivalled user convenience and safety.



- Minimalist low profile design in black or white
- TUF HP high power USB charging option
- Simple installation into 80mm* grommet apertures
- Wide range of Data & AV options



*Capable of fitting into Ø76 - 80mm (3.00-3.15")

technical

Modular components



TUF HP



Blank fascia



Removable blank fascia



HDMI keystone coupler

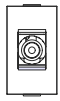

Stereo keystone coupler

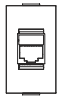

Cat5e/Cat6 Data

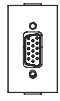

VGA 300mm M-F

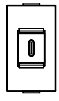

USB type C keystone ext cable



USB 3.0 Type A keystone ext cable

Dimensions

Ø108.00

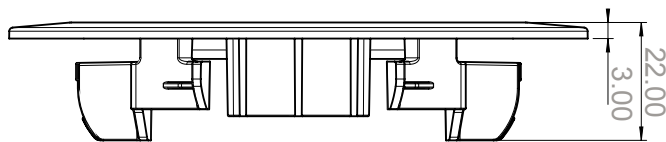
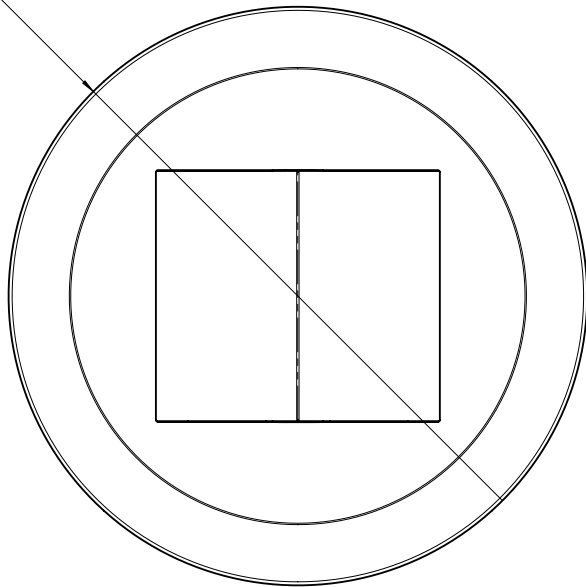

Cutout Dimensions

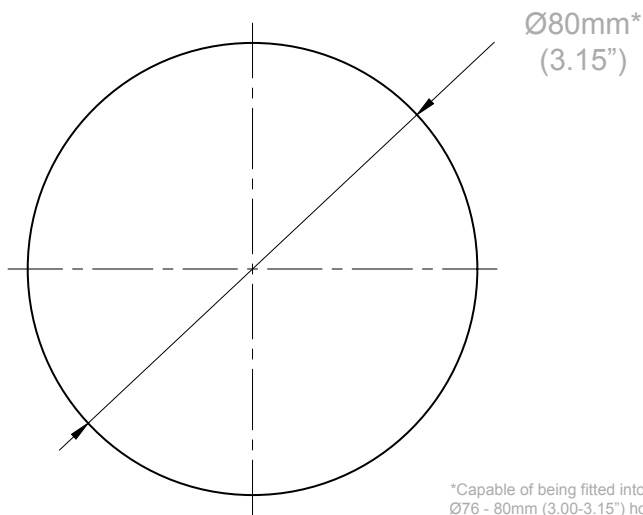

*Capable of being fitted into a Ø76 - 80mm (3.00-3.15") hole

Configuration:

PORT can be fitted with the following QF05 modules :

- TUF-HP*
- Blank fascia
- Removable blank fascia
- HDMI keystone coupler
- 3.5mm stereo keystone coupler
- Cat5e/Cat6 data
- VGA 300mm M-F
- USB type C keystone ext cable
- USB 3.0 Type A keystone ext cable
- Pull through fascia (please enquire)

*Note: QF05 TUF-HP will require connection to a QIKFIT Power Supply or QIKPAC battery via a GST08 power lead.

Construction

High strength fire retardant polycarbonate

Colours:

Black or white (RAL9003)

Installation:

QF PORT fits into a Ø80mm* grommet hole and is securely held in place by 2 screws.

QF05 modules snap fit into port using their integrated retaining clips

Quality & Testing:

QIKFIT PORT is UK manufactured using ISO9001 quality controlled components and practices and if ordered preconfigured is 100% tested before dispatch:

- Visual: Configuration and appearance.
- USB charger: Output voltage and resistance
- Data & AV: All sockets continuity tested with batch performance testing.

"We test every pin in every socket in every module"

Certifications:

The optional QF05 TUF HP USB charging module, QIKFIT power supply and QIKPAC battery have extensive international safety, EMC and ROHS certification. See the model specific data sheets for full information.

QF05 TUF HP USB datasheet [download here](#)

QIKFIT30 PSU (power supply) datasheet [download here](#)

QIKPAC battery datasheet [download here](#)